

CLIENT: ADMINISTRATION DEPARTMENT OF THE KRASNODAR REGION

PERIOD: 2007

LOCATION: KRASNODAR (RUSSIA)

DESCRIPTION: 53.884 m<sup>2</sup> - 830 BEDS

WORK VALUE: € 64.054.144

SERVICES PROVIDED: PROJECT MANAGEMENT FOR DESIGN SERVICES FOR PRELIMINARY DESIGN



PLAN WITH EXTERNAL WORKS

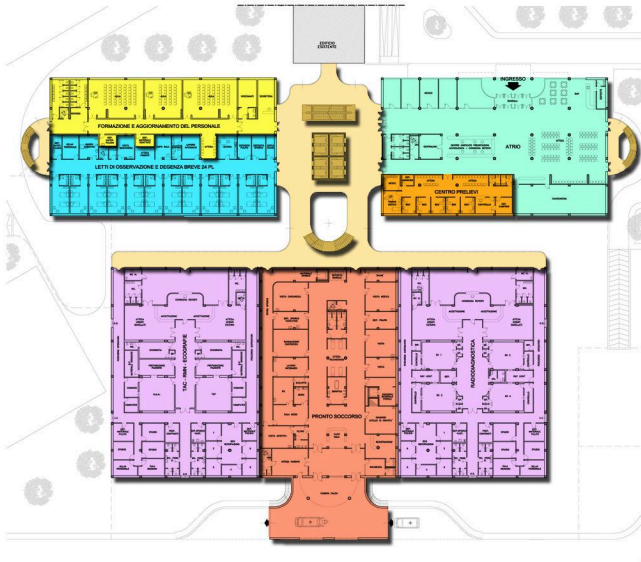
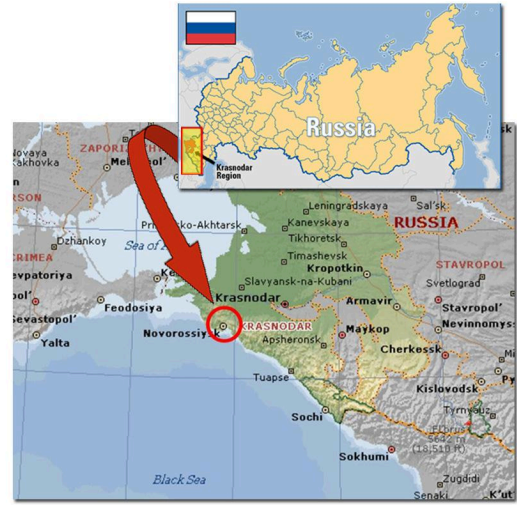

GROUND FLOOR PLAN

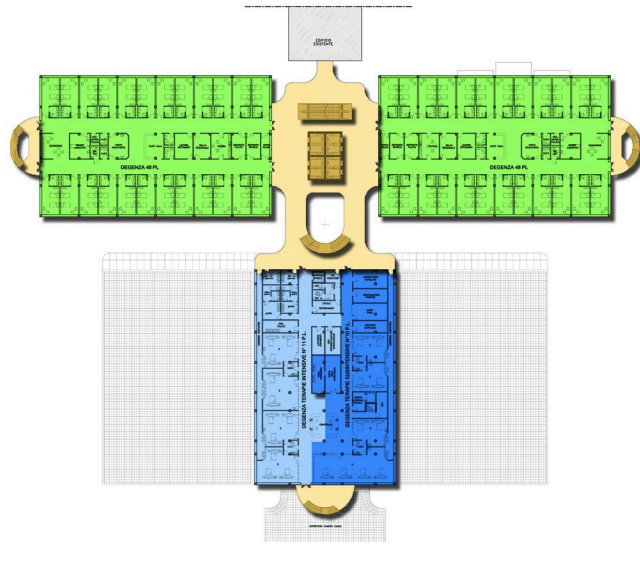

FIRST FLOOR PLAN

Livello tecnologico	Superficie Sviluppata
<b>ALTO</b>	
Gruppo operatorio	3 585,00
Rian., Ter.Int.,U.C.	597,50
Dialisi	597,50
P. Socc. E Cam.Calda	1 448,00
Ter. Sub intensiva	597,50
Radiologia	1 281,00
TAC, RMN, ecogr.	1 281,00
Serv. Emotrasf. Labor.	597,50
<b>Totale</b>	<b>9 985,00</b>
<b>MEDIO</b>	
Degenza indiff.	20 608,00
Letti osserv./deg. Breve	723,00
Recupero e rieduc. Funz.	1 195,00
Lab./Centro Trasn.	1 195,00
Centro prelievi	224,00
Area settoria Anatom. Pat.	509,00
<b>Totale</b>	<b>24 454,00</b>
<b>BASSO</b>	
<b>Basso livello</b>	
Farmacia	770,00
Reparto Morgue	612,00
Sterilizzazione	648,00
Cucina centr./mensa	2 530,00
Lavanderia/guardaroba	884,00
Magazzini/depositi	505,00
<b>Totale</b>	<b>5 949,00</b>
<b>Servizi generali di supporto</b>	
Dir. Ammin. E Sanit.	1 195,00
Locali vari (CUP,inform., bar, attesa, guardar.,consegna referiti, centr. Tel., negozi, ecc.)	1 064,00
Aula formaz. Aggiornam. Personale	565,00
Spogl. Personale	950,00
Connettivo, scale, ascensori, atrio	8 536,00
<b>Totale</b>	<b>12 310,00</b>
<b>Servizi generali tecnici</b>	
Dolcific. Acqua, locale pompe, cabina	1 186,00
<b>Totale</b>	<b>1 186,00</b>
<b>Totale BASSO</b>	<b>19 445,00</b>
<b>TOTALE</b>	<b>53 984,00</b>

LEGEND

- EMERGENCY AND ACCIDENT DEPARTMENT
- RADIOLOGY/ DIAGNOSTIC RADIOLOGY
- URGENCIES
- INTENSIVE CARE UNIT
- SUB-INTENSIVE CARE UNIT
- WARDS AND INPATIENT ROOMS
- HALL
- TRAINING/UPDATING OF THE STAFF
- TRANSFUSIOLOGY
- OPERATING UNIT
- CORRIDORS
- STAIRS - ELEVATORS

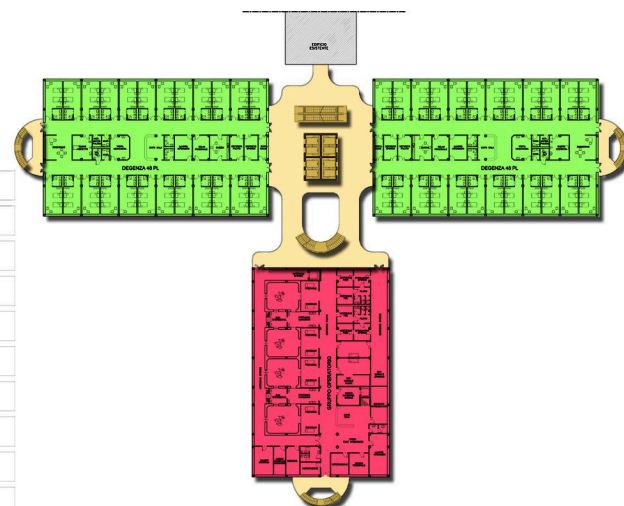

TYPE FLOOR PLAN