

CLIENT: MINISTRY OF HEALTH OF THE REPUBLIC OF CONGO-BRAZZAVILLE
 PERIOD: 1999
 LOCATION: BRAZZAVILLE (CONGO-BRAZZAVILLE)
 DESCRIPTION: 19,854 m² - 350 BEDS (EXPANDABLE TO 450 BEDS)
 WORK VALUE: € 39,150,000
 SERVICES PROVIDED: PRELIMINARY DESIGN



NORTH-WEST FACADE



NORTH-EAST FACADE



SECTION A-A

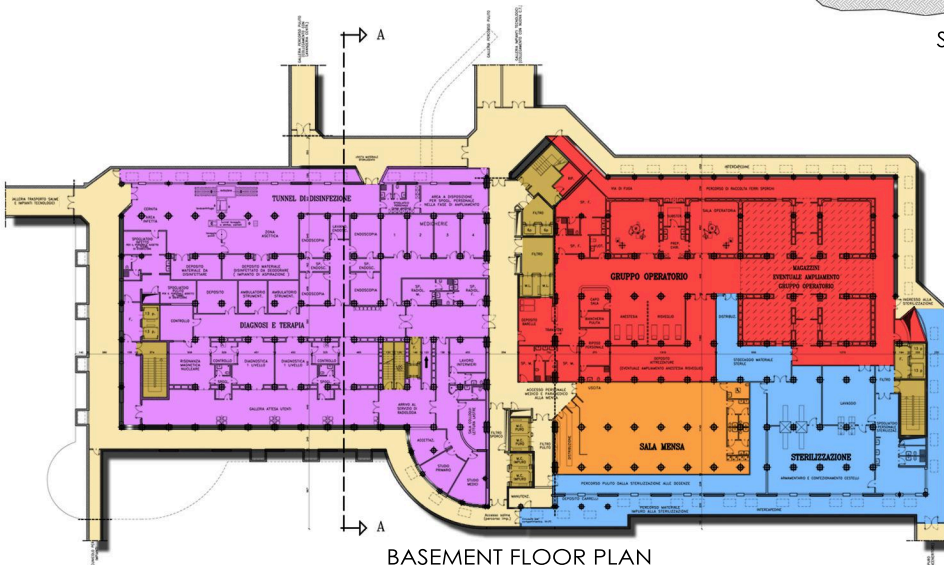



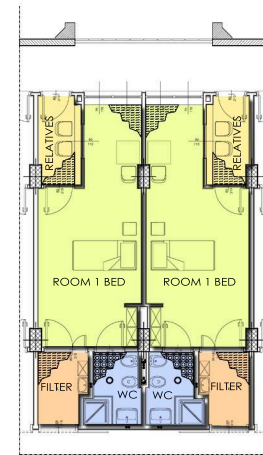







BASEMENT FLOOR PLAN



INPATIENTS ROOM



TYPE FLOOR PLAN

LEGEND	
	HALL
	RADIOLOGY/DIAGNOSTIC RADIOLOGY
	CANTEEN
	CENTRALIZED STERILIZATION
	OPERATING UNIT
	DAY-HOSPITAL
	WARDS AND INPATIENT ROOMS
	LABORATORIES
	CORRIDORS
	STAIRS - ELEVATORS