

COMMETTANT: MINISTÈRE DE LA SANTÉ DE LA RÉPUBLIQUE DU CONGO-BRAZZAVILLE

ANNÉE: 1999

LIEU: BRAZZAVILLE (CONGO-BRAZZAVILLE)

DESCRIPTION: 19,854 m² - 350 LITS (EXTENSIBLE À 450 LITS)

MONTANT DES TRAVAUX: € 39,150,000

SERVICES OFFERTS: PROJECT MANAGEMENT DU SERVICES DE CONCEPTION POUR PROJET PRÉLIMINAIRE



FAÇADE NORD-OUEST



FAÇADE NORD-EST



COUPE A-A

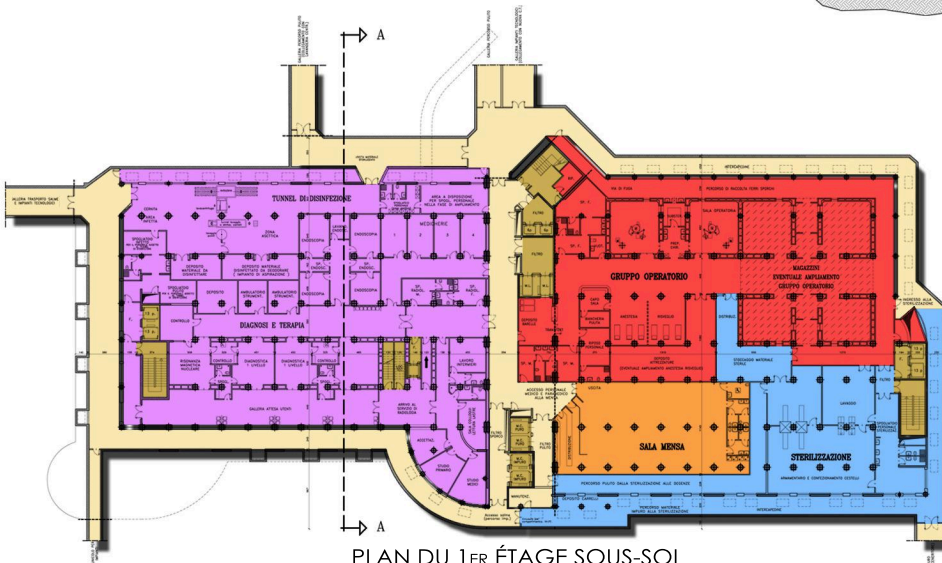



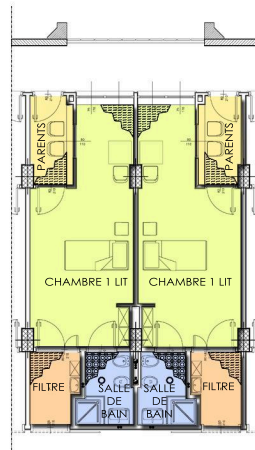



PLAN DU 1^{ER} ÉTAGE SOUS-SOL

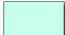

CHAMBRE D'HÔPITAL

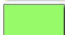
LÉGENDE

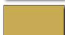
	HALL
	RADIOLOGIE/RADIOLOGIE DIAGNOSTIQUE
	CANTINE
	STÉRILISATION CENTRALISÉE
	GROUPE CHIRURGICAL
	CHIRURGIE D'UN JOUR
	HOSPITALISATION
	LABORATOIRES
	COULOIRS
	ESCALIERS - ASCENSEURS



PLAN TYPE

