

COMMITTENTE: MINISTERO DELLA SANITA' DELLA REPUBBLICA DEL CONGO-BRAZZAVILLE
 ANNO: 1999

LUOGO: POINT-NOIRE (CONGO-BRAZZAVILLE)

DATI TECNICI: 19.854 m² - 350 p.l. (AMPLIABILI A 450)

IMPORTO LAVORI: € 39.150.000

SERVIZI PRESTATI: PROJECT MANAGEMENT DEI SERVIZI DI PROGETTAZIONE PRELIMINARE



PROSPETTO SUD-EST

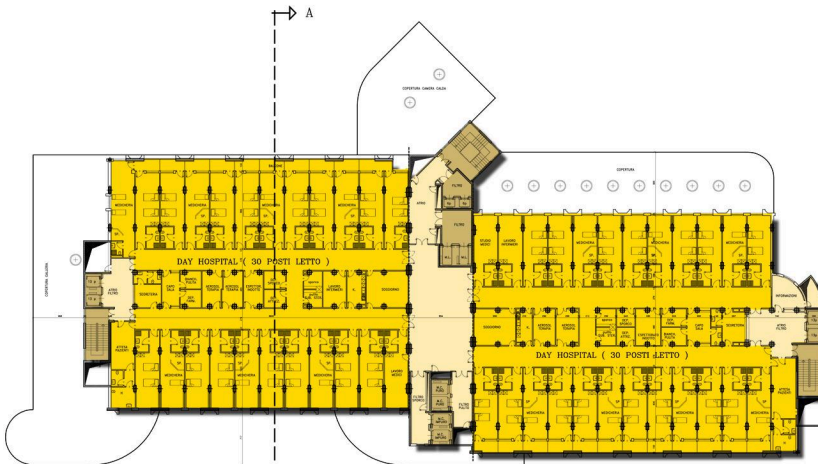
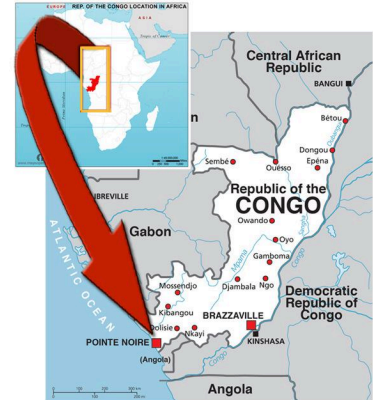

PIANTA PIANO PRIMO



FABBRICATO TECNOLOGICO -
PIANTA PIANO INTERRATO



PIANTA PIANO TIPO

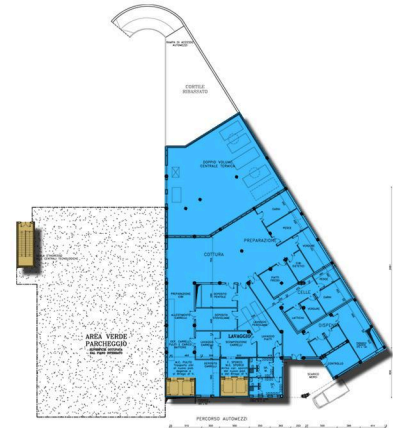



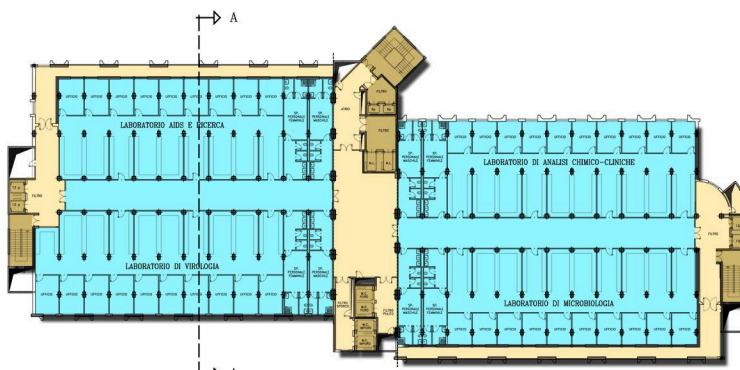

FABBRICATO TECNOLOGICO -
PIANTA PIANO TERRENO

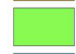

PIANTA PIANO SESTO

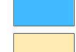
LEGENDA

	DAY-HOSPITAL
	DEGENZE E SERVIZI ACCESSORI
	LABORATORI
	CUCINA CENTRALIZZATA
	SERVIZI TECNICI
	CORRIDOI
	SCALE - ELEVATORI

