

CLIENT: CHAMBER OF AGRICULTURE OF IVORY COAST

PERIOD: 1998

LOCATION: IVORY COAST

DESCRIPTION: 8,281 m² - 356 BEDS

WORK VALUE: \$ 14,650,000

SERVICES PROVIDED: PROJECT MANAGEMENT FOR DESIGN SERVICES FOR PRELIMINARY DESIGN

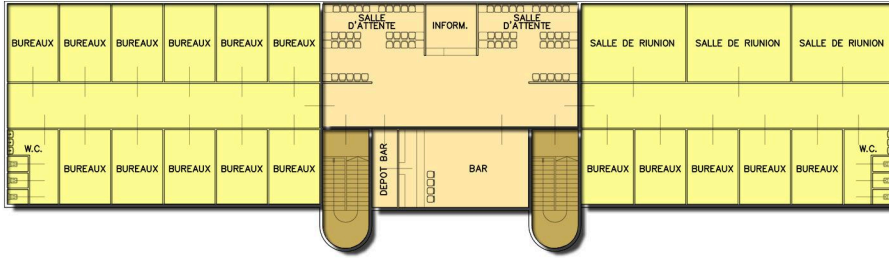

FIRST FLOOR PLAN

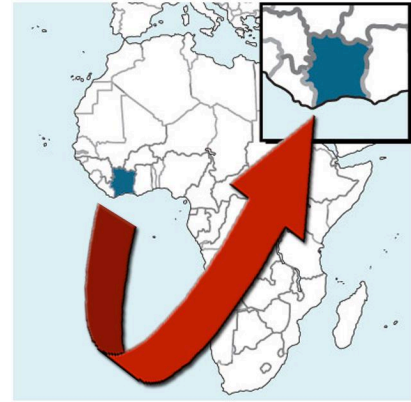

LEGEND							
	HALL		STERILIZATION		RESUSCITATION INTENSIVE CARE		KITCHEN
	RADIOLOGY		OPERATING UNIT		EMERGENCY MEDICINE		TECHNICAL SERVICES
	HOMEOPATHY		OUTPATIENT CLINICS		WARDS AND INPATIENT ROOMS		MORGUE
	LABORATORIES		PHYSIOTHERAPY		OFFICES		CORRIDORS
	OBSTETRICS-GYNECOLOGY-NURSERY		CORONARY UNIT		CANTEEN		STAIRS - ELEVATORS

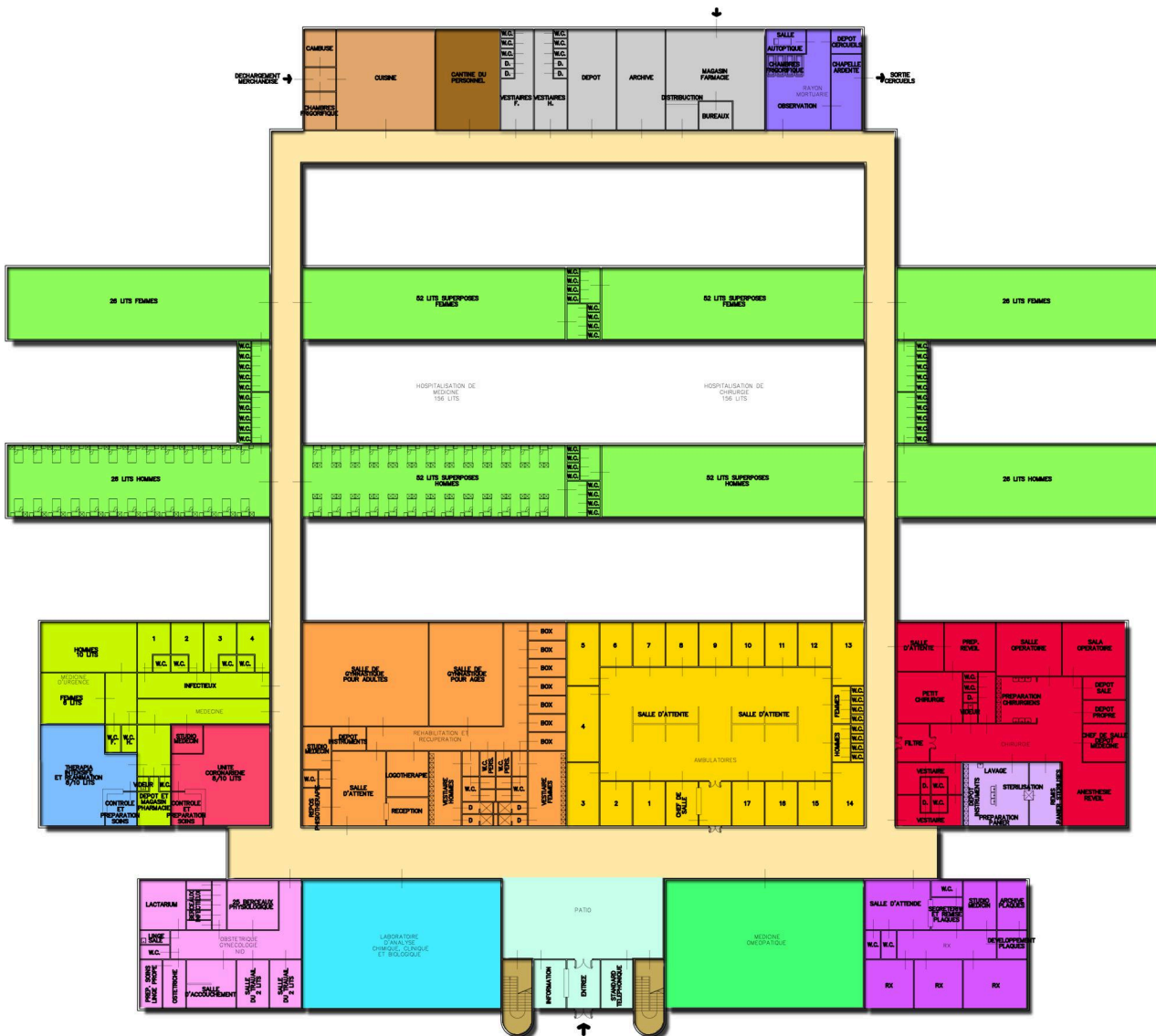

GROUND FLOOR PLAN