

CLIENT: ENTE OSPEDALIERO CANTONALE

PERIOD: 2016

LOCATION: BELLINZONA (SWITZERLAND)

DESCRIPTION: 3,220 m²

SERVICES PROVIDED: PROJECT MANAGER AND TEAM LEADER OF THE TECHNICAL EVALUATION TEAM



ANALYSIS OF THE ARCHITECTURAL SOLUTIONS IDENTIFIED FOR THE ENLARGEMENT OF THE REGIONAL HOSPITAL OF BELLINZONA AND VALLEYS INTENSIVE CARE AND THE OPERATING UNIT IN THE REGIONAL HOSPITAL OF BELLINZONA AND VALLEYS



INTENSIVE CARE - CLIENT'S PROPOSAL



INTENSIVE CARE - PROPOSED CHANGE



OPERATING UNIT - CLIENT'S PROPOSAL

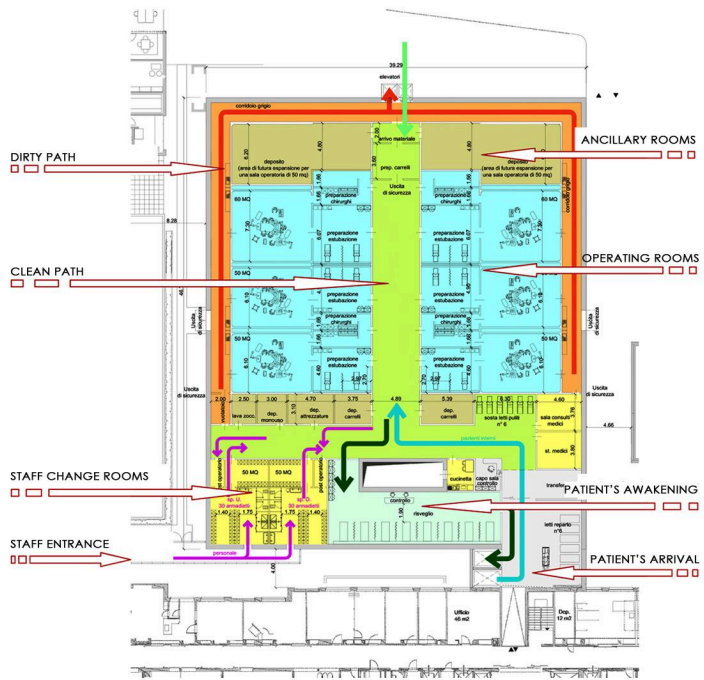

OPERATING UNIT - PROPOSED CHANGE